

Jackson Homes Severance Sketch
 Weedmark Road Vacant Lot
 Part Lot 9, Concession 7
 Township of Montague
 COUNTY OF LANARK

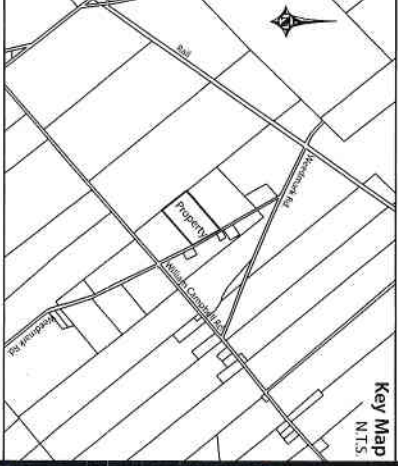

- Legend**
- Significant Wooded Areas
 - Watercourse

Notes:

1. Location of the watercourse and Significant Wooded Areas derived from the Township of Montague Official Plan Schedules;
2. An EIS was completed for the property by Geofirma Engineering which did not result in any significant constraints or natural heritage features being found. The EIS did not locate or note the presence of any watercourse on the property;
3. Boundary and dimensions of the subject property are approximate and not based on a survey plan.

