

# Stanley - Smith Severance Sketch

2321 Lanark 9th Concession B  
Part Lots 21 & 22, Concession 8  
Geographic Township of Lanark  
Township of Lanark Highlands  
COUNTY OF LANARK

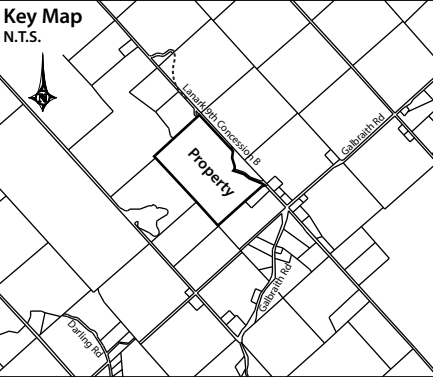

- Legend**
- Portion of Road Allowance to be Closed
  - Portion of Property to be Conveyed
  - Locally Significant Wetlands
  - Non-Evaluated Wetlands
  - Minimum 30m Wetland Setback
  - Organic Soils
  - Mineral Aggregate Reserve
  - Watercourse
  - Hydro Easement
  - Travelled Road

**Notes:**

1. The driveway access northwest of Proposed Severance #1 is to remain with the Retained Lands.
2. Location of the Locally Significant and Non-Evaluated Wetlands derived from the Mississippi Valley Conservation Authority Online GIS mapping and are shown approximately.
3. Location of organic soils and mineral aggregate reserves derived from the Township of Lanark Highlands Official Plan Schedule B and are shown approximately.
4. Boundary and dimensions of the subject property are approximate and not based on a plan of survey.

