

30x22
ATTIC
ACCESS

BEDROOM
8'-8" x 9'-11"

BEDROOM
8'-8" x 10'-10"

DECK
9'-8" x 7'-8"

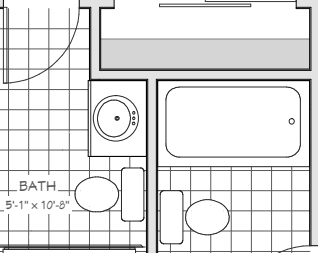

BATH
5'-0" x 8'-3"

CLOSET
3'-8" x 3'-1"

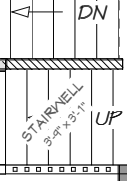

HALL
4'-8" x 21'-3"

OPTIONAL GARAGE
19'-1" x 19'-3"

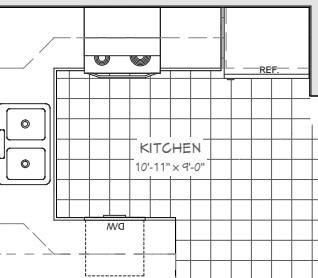

MW

REF

DINING
10'-11" x 12'-1"

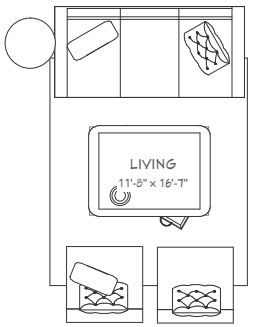
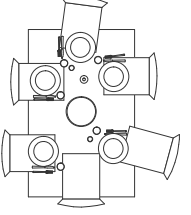

LOWER ENTRY
6'-0" x 14'-11"

CONCRETE PORCH
5'-11" x 7'-6"